



THE BEST ARCHITECTURE SOLUTION

FROM OFFSHORE TO CRUISE



BS MARINE

Take a drive into our SEA OF POSSIBILITIES

BS MARINE is a turn-key supplier of certified interior systems for the shipbuilding industry.

Our product range is suited for the accommodation of Off-shore platforms, cruise ships, passenger vessels, cargo vessel, coasters and even container module.

It consists out of : wall panels, ceiling panels, flooring, sanitary units, interior doors, window, furniture.

We are able to assist and advise architects, contractor and owners from the start of the project, tackling designing challenges in an early stage.

We provides its clients with optimal space design and efficient installation solutions.



BS MARINE



ENGINEERING

Concept design proposal
General Arrangement
Detail Design for material



PROCUREMENT

Architecture material
Interior material
Equipment



QUALITY CONTROL

Design Quality
Material Quality
Installation Quality



TURN-KEY ARCHITECTURE SYSTEM



MANAGEMENT

Master Plan for building
Schedule for detail

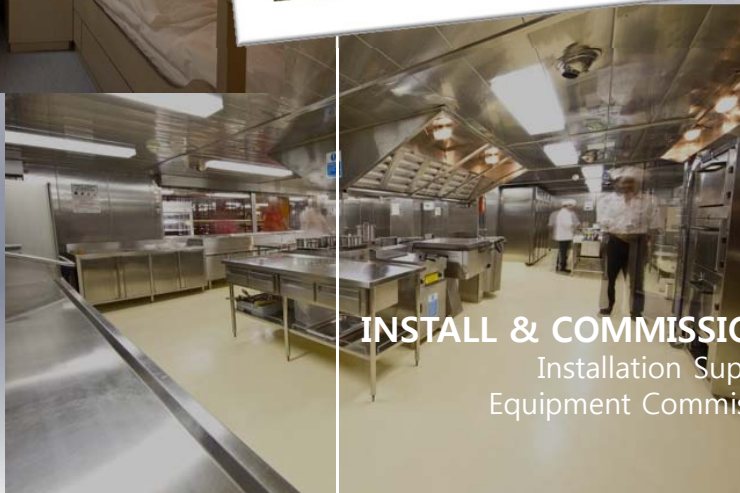

INSTALL & COMMISSIONING

Installation Supervising
Equipment Commissioning



INTERIOR & FURNISHING

Comfort and functional design considering human factor. Furniture is strong, light and esthetic



Characteristics

- Taylor made furniture
- Durable metal & wooden furniture without corrosion
- Non-combustible material or finish
- Available Recycling
- No harmful element arise

Suppliers

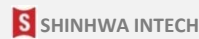

PANELS (Wall Panel)

Various optimum type of panels for conventional or modular system

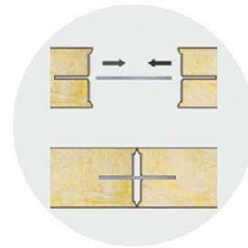

spline joint connection

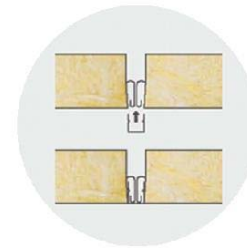

clip joint connection

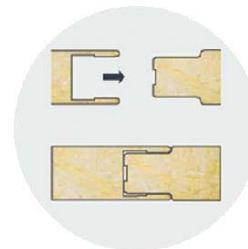

insert type connection

TECHNICAL SPEC.	DESCRIPTION
Fire Class	B0 ~ A60 class
Sound Reduction	Rw 31 ~ 46 dB
Core Material	Mineral Wool
Surface Material	0.6~0.7mm galvanized steel plate
Finish	150 μ m PVC film with protective foil
Thickness	25 ~ 100mm
Width	550 ~ 600mm
Length	2200 ~ 3000mm (Max.)

Suppliers



PANELS (Ceiling Panel)

Various optimum type of panels for conventional or modular system

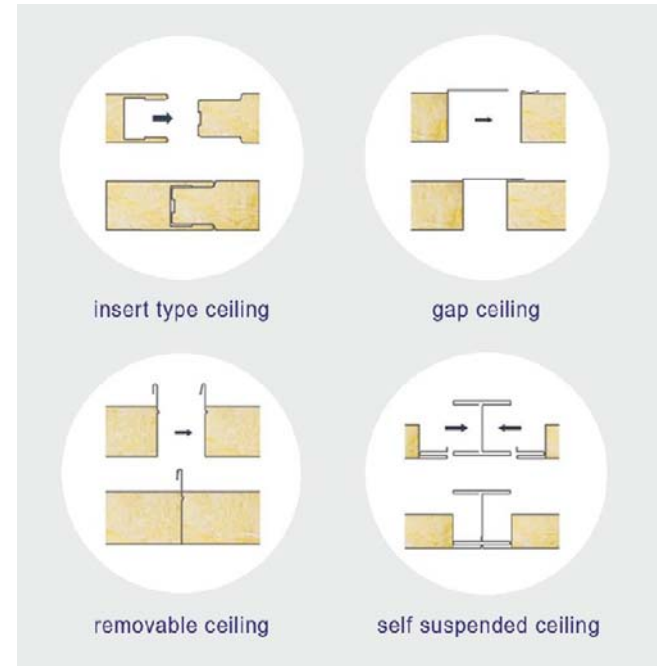
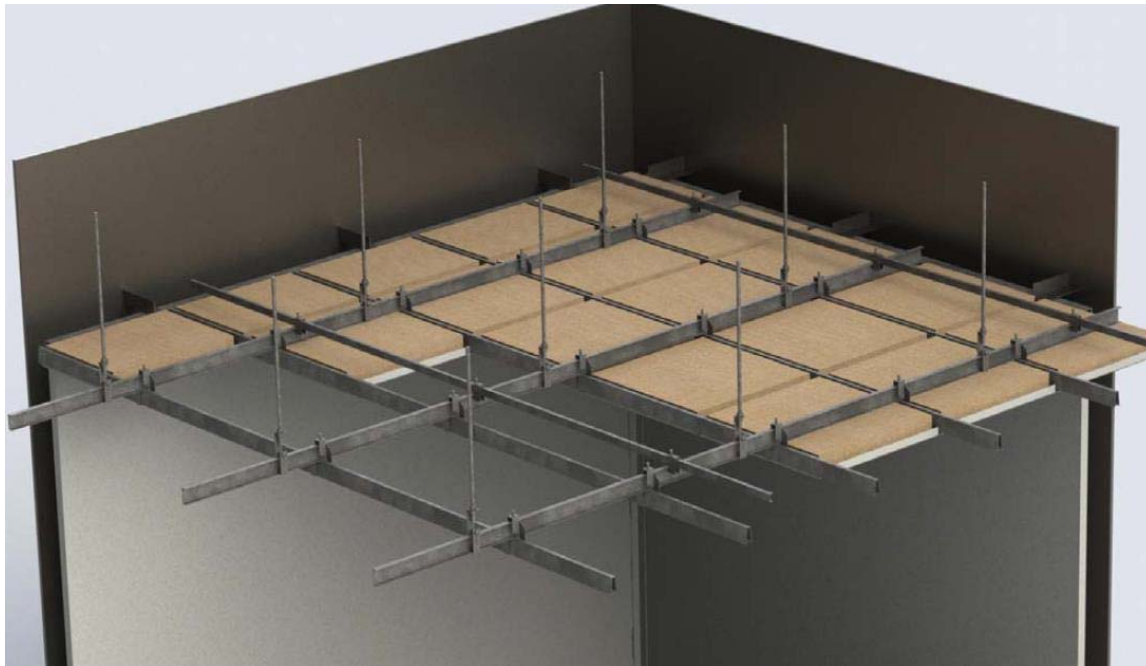

TECHNICAL SPEC.	DESCRIPTION
Fire Class	B0 ~ B15 class
Sound Reduction	Dn,c,w 38 ~ 54 dB
Core Material	Mineral wool
Surface Material	0.6~0.7mm galvanized steel plate
Finish	150 μ m PVC film with protective foil Or Baked Enamel Paint
Thickness	25 ~ 75mm
Width	300 ~ 600mm
Length	600 ~ 3000mm (Max.)

Suppliers



INTERIOR DOORS

The interior doors are built with excellent durability to withstand impacts and boast top quality and safety

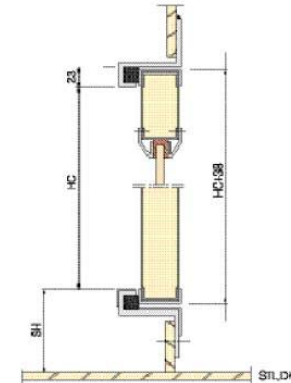
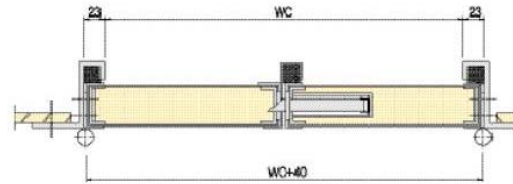

TECHNICAL SPEC.	DESCRIPTION
Fire Class	B15 ~ A60 class
Sound Reduction	Rw 32 ~ 45 dB
Core Material	Mineral wool
Door Leaf	38~48mm galvanized steel plate
Door Leaf Finish	150 μ m PVC film with protective foil or Baked enamel paint
Door Frame	1.6 ~ 4mm Steel, Stainless Steel
Door Frame Finish	Baked enamel powder coat or Stainless steel
Hinge	600 ~ 3000mm (Max.)
Sill	Marine grade stainless steel
Lever Handle	Marine grade stainless steel
Accessories	Lock Case, Handles, Cylinder, Door Closer, ETC.

Suppliers



MODULAR UNIT

Prefabricated modular unit. It is self-supported unit and has wide range of variation for size and type

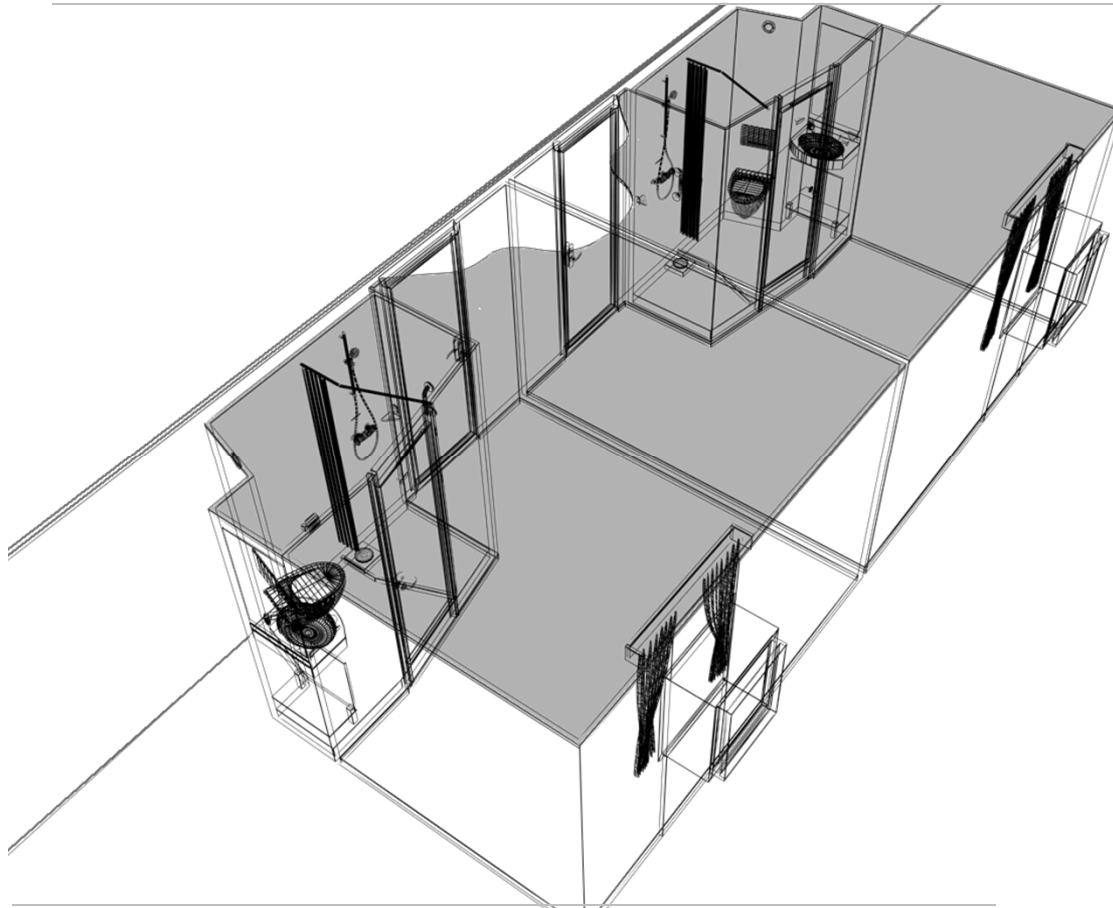

TECHNICAL SPEC.	DESCRIPTION
Fire Class	B0 ~ B15 class
Sound Reduction	Rw 31 ~ 46 dB
Core Material	Mineral wool
Surface Material	0.6~0.7mm galvanized steel plate
Finish	150 μ m PVC film
Weight	1.5 ~ 3.0 ton
Size	Various

Suppliers



MODULAR WET UNIT

Prefabricated modular unit.

It can be made with various material and has high quality and durability



TECHNICAL SPEC.	DESCRIPTION
Fire Class	B0 ~ B15 class
Core Material	Mineral wool
Surface Material	0.6~0.7mm galvanized steel plate , Stainless steel, FRP
Finish	150 μ m PVC film , Tile, Natural stone
Floor Element	Steel, Stainless Steel, FRP
Weight	400 ~ 550 kg
Size	Various

Suppliers



FLOORING

Optimum deck covering solution according to site environment and status.
CE and ISO9001 certified product

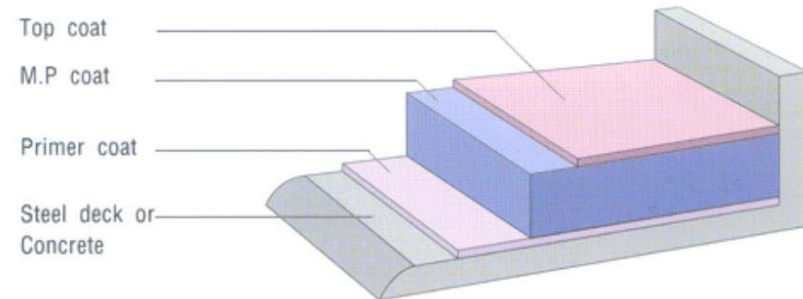

Characteristics

- Self leveling property
- Excellent adhesive strength
- Good elasticity
- Non-combustibility
- Good chemical and abrasion resistances
- Easily controllable thickness
- Easy handling and economic benefit

Suppliers



LIGHTING FIXTURE

Lighting for accommodation must be durable and strong to the humidity, and be installed as to withdraw wind and waves

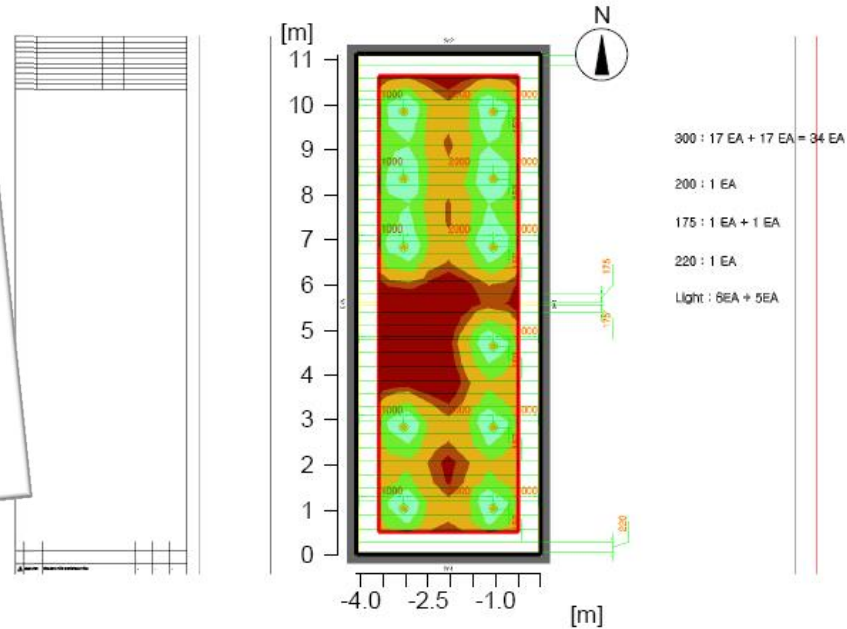

TECHNICAL SPEC.	DESCRIPTION
Application	Accommodation
Type	Various
Protection	IP20 ~ 65
Material	Electro zinc coated steel
Finish	Epoxy powder coat and stove enameled
Lamp	Fluorescent lamp or LED
Electrical	AC100~240V, 50/60Hz
Ballast	Glow, Electronic



Suppliers





THE BEST SCHEDULING

Offering optimum schedule for project
For saving time and cost

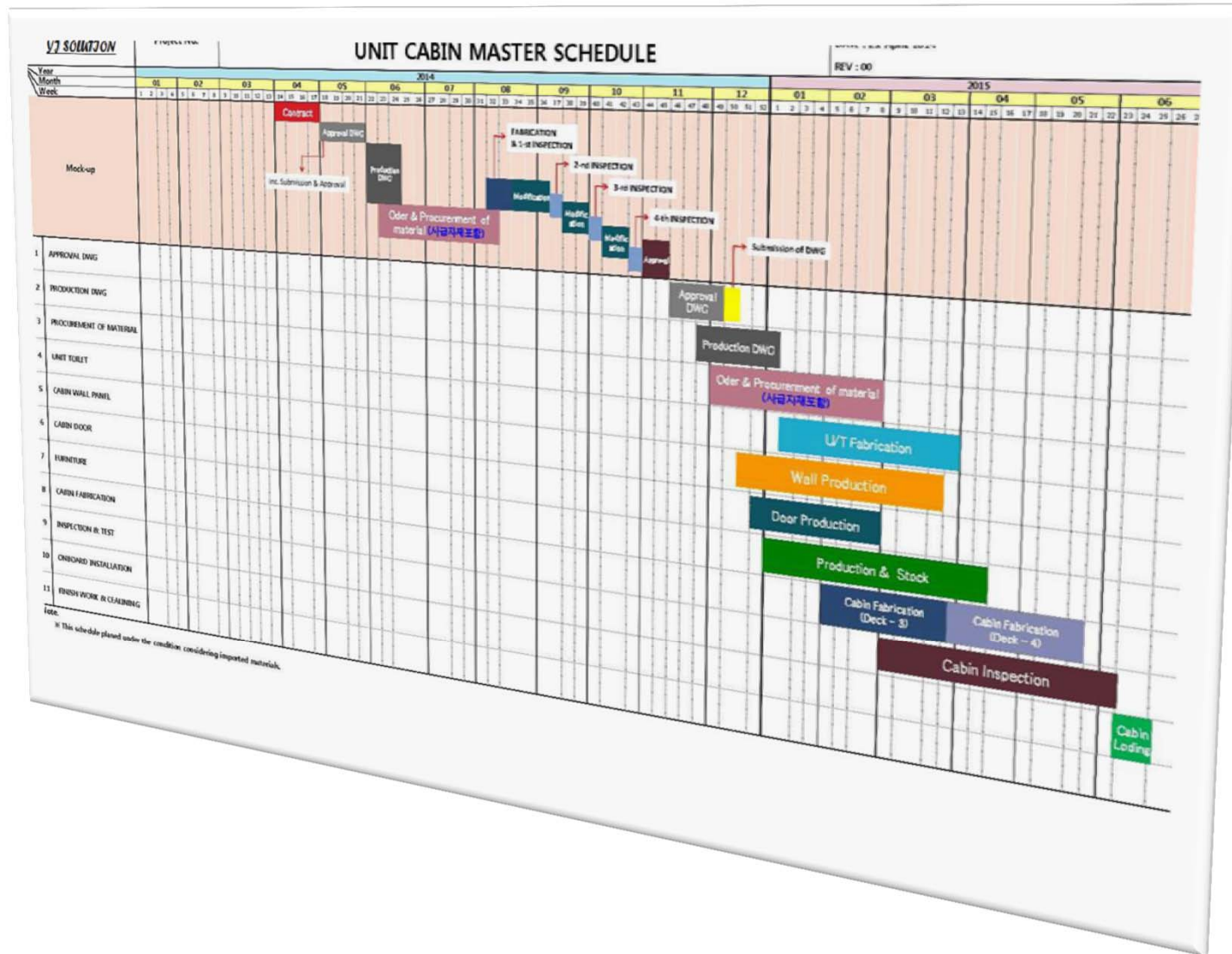

THE BEST SUGGESTION

- Uploading method
- Installation sequence
- Weight control
- Material selection

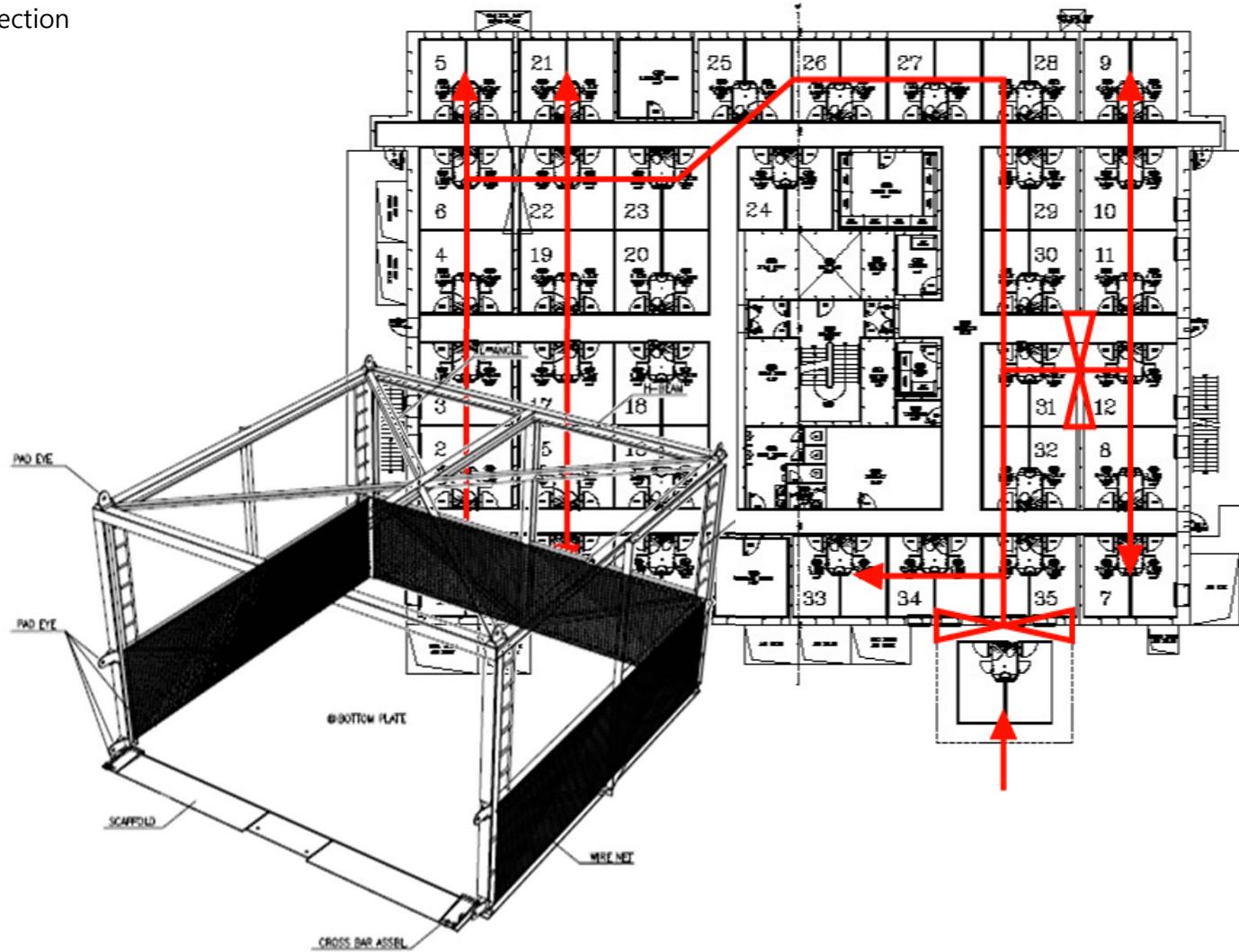

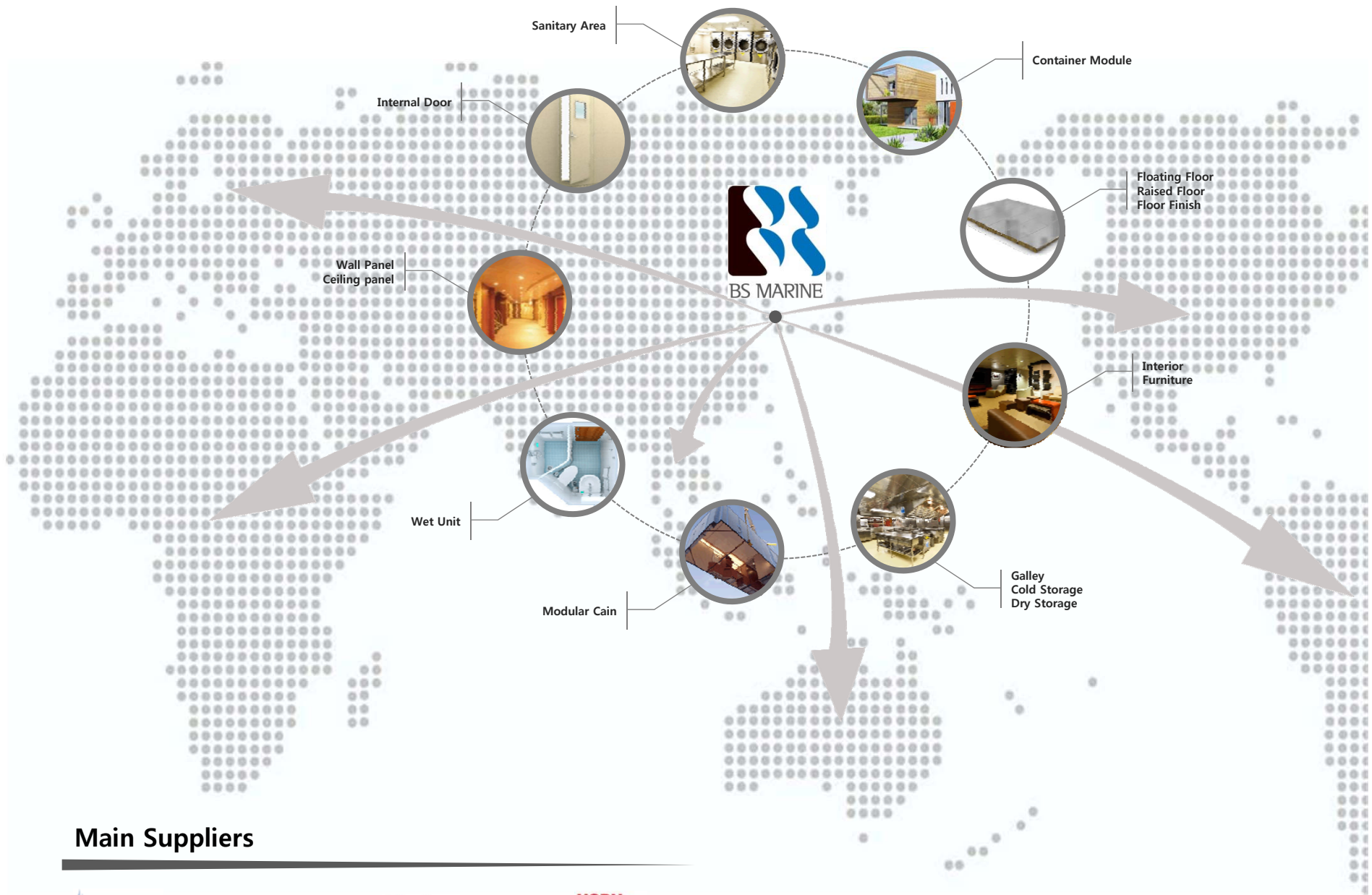

Main Suppliers

